

 AVIONAUT

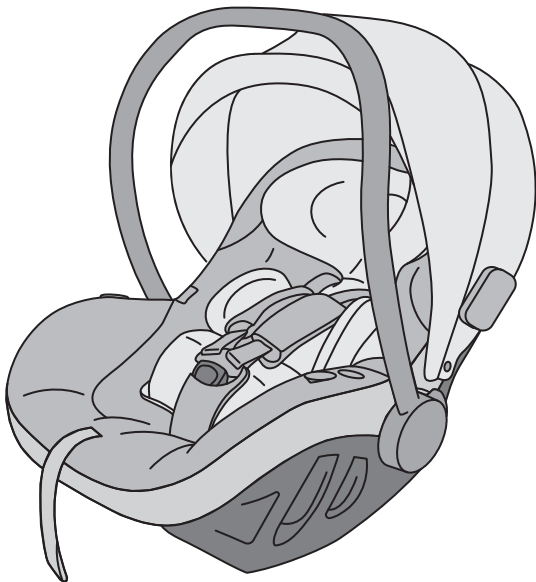

Pixel PRO 2.0 C

40 cm - 86 cm / max. 13 kg

- Инструкција за употреба & Гаранција
- Návod k obsluze & Záruka
- Bedienungsanleitung & Garantie
- Betjeningsvejledning & Garanti
- Οδηγίες χρήσης & Εγγύηση
- User's manual & Warranty
- Instrucciones de uso y Garantía
- Kasutusjuhend ja garantiitingimused
- Käyttöohjeet ja takuu
- Manuel d'utilisation & Garantie
- יחרא & הכרדה תרבוה
- Upute za uporabu i jamstvo
- Használati útmutató és Garancia

- Istruzioni d'uso e Garanzia
- Naudojimo instrukcija ir garantija
- Lietošanas pamācība & garantija
- Bruksanvisning og garanti
- Instrukcja obsługi & Gwarancja
- Manual de instruções & Garantia
- Instrucțiuni de utilizare & Garanție
- Руководство по эксплуатации & Гарантия
- Bruksanvisning och garanti
- Návod na obsluhu & Záruka
- Navodila za uporabo in Garancija
- Kullanım Kılavuzu ve Garanti
- Інструкція з експлуатації та гарантія



User's manual for the Avionaut® Pixel PRO 2.0 C™ child safety seat

Important!

Do not read this manual hastily. Read it carefully, save it for the future and keep it always at hand. If in doubt, please contact us. Please travel safely and treat each car ride seriously. Even when the destination is only a few blocks away.

We recommend that the instructions shall be kept with the car seat during its life period.



Warning:

Do not modify the Pixel PRO 2.0 C child safety seat in any way, as it may affect the child's safety during its use.



Warning:

Never place the Pixel PRO 2.0 C child safety seat on an elevated surface, e.g. on a table or chair.



Warning:

Never install the Pixel PRO 2.0 C child safety seat facing backwards to the driving direction in the front passenger seat with an active airbag.



Attention:

The Pixel PRO 2.0 C child safety seat should only be installed in the car facing backwards to the driving direction.



Warning:

For more information, please refer to the vehicle manufacturer's handbook.

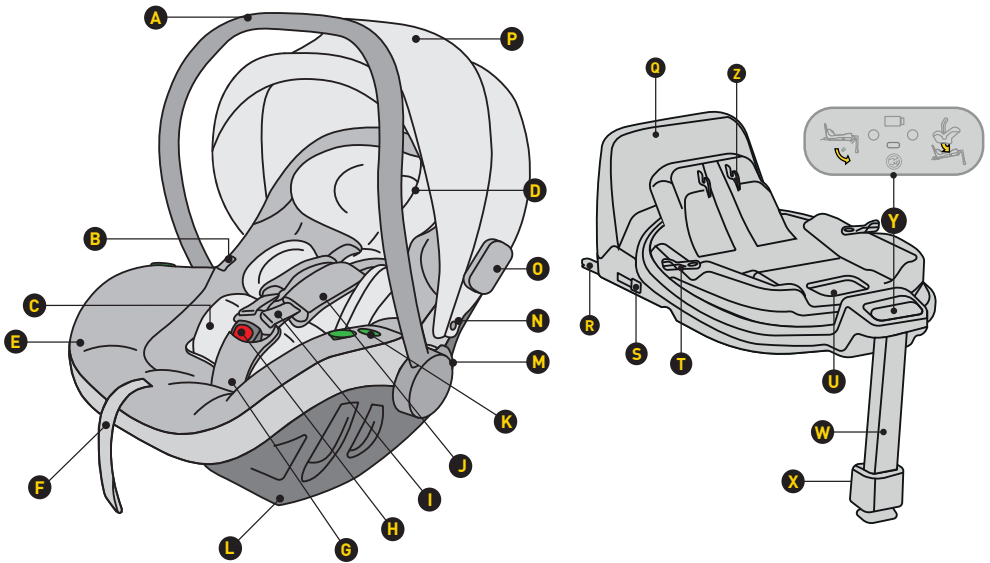

- A Handles
- B Button to release seat from stroller
- C Pixel PRO 2.0 C height adjustment system
- D Pixel PRO 2.0 C insert
- E Seat cover
- F Seat belt length adjuster
- G Seat belt with protector
- H Seat belt lock
- I Shoulder belts
- J Shoulder belts with detachable protectors
- K Hip belt connector
- L Base attachment
- M Button to adjust handle setting
- N Canopy attachment

- O Reflector
- P Sun canopy
- Q Anti-rotation frame
- R ISOFIX base attachment
- S Button to release ISOFIX connector
- T Rotation button
- U Release lever to unlock seat
- W Adjustable footrest
- X Footrest adjustment button
- Y Control panel
- Z Seat attachment mechanism at attachment mechanism

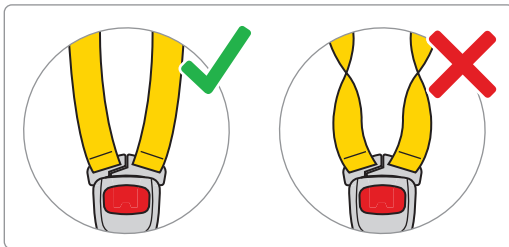
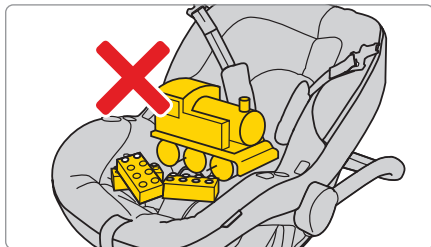
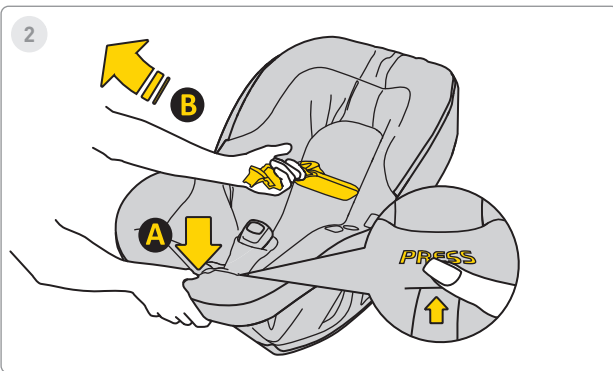
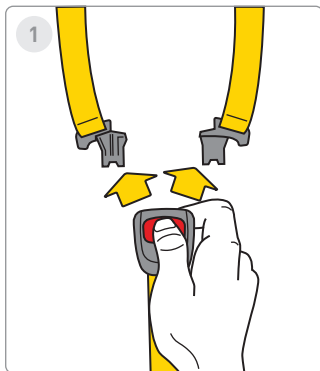

1 Step

Press the red buttons to release the car seat buckle.

2 Step

Loosen the car seat belts to make room for the child in the car seat. Press button **A** and pull belts **B**, to increase their length.

Remember! No other objects should be in the car seat, and the safety belts should always be straight and properly fastened!



3

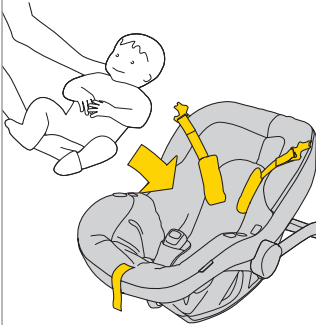

4

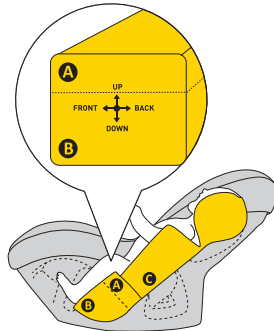

ca. 40-55cm

5

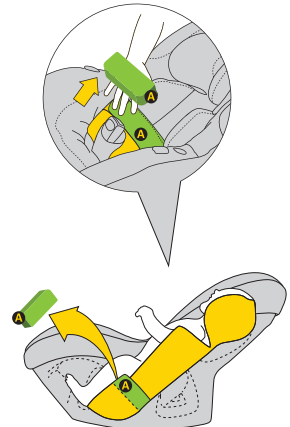

ca. 55-60cm

3 Step

Move the straps to the sides of the car seat. Place the child in the car seat. Make sure that your child sits properly in the car seat with their back completely against the car seat, and no part of the straps is under the child's back.

4 Step

If your child reaches a height of 40-60cm, use the full cushion insert **A** + **B**.

5 Step

When your child reaches a height of 55-60cm, adjust the cushions to the child's height.



6

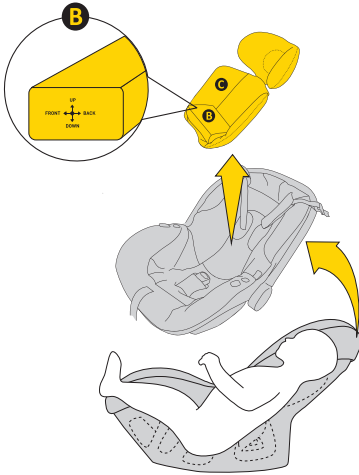

ca. >60cm

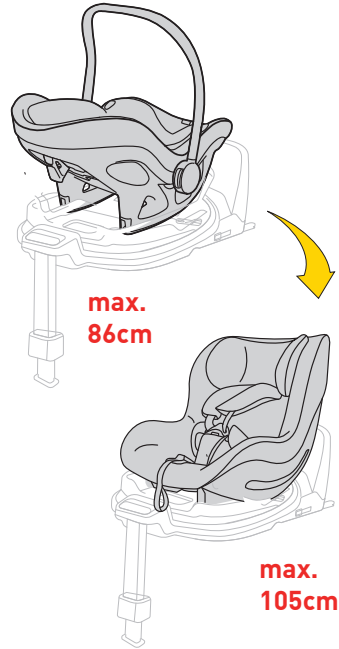

6 Step

When your child exceeds 60cm in height, you can use the car seat without the insert.

If your child reaches a height of 40-60cm, use the full cushion insert.



WARNING!

The indicated height measurements regarding the child in relation to the insert arrangement are mere SUGGESTIONS. Each child is different and grows at a different rate, so the ABSOLUTE priority in adjusting the insert is the level of the straps in relation to the child's shoulders. REMEMBER – THE STRAPS SHOULD COME OUT AT OR JUST BELOW SHOULDER LEVEL.



7

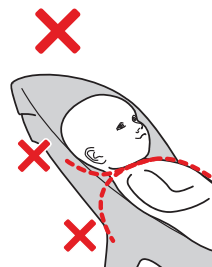
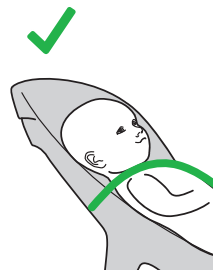
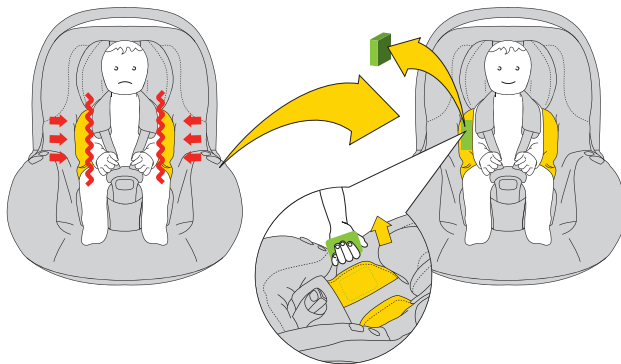

7 Step

When you notice that your child needs more space in the car seat, remove the side EPS inserts from the cushion.

If your child reaches a height of 40-60cm, use the full cushion insert.

WARNING!

The indicated height measurements regarding the child in relation to the insert arrangement are mere SUGGESTIONS. Each child is different and grows at a different rate, so the ABSOLUTE priority in adjusting the insert is the level of the straps in relation to the child's shoulders. REMEMBER – THE STRAPS SHOULD COME OUT AT OR JUST BELOW SHOULDER LEVEL.



8

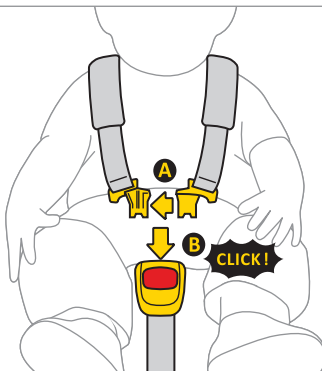

9

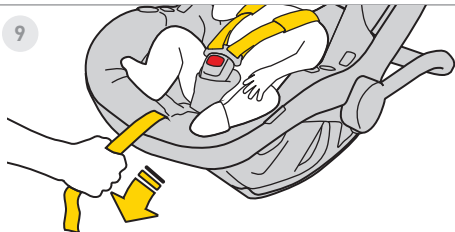

10



8 Step

Connect clip **A** of the belts together, then insert the plastic clips **A** into the slot of clip **B**. A click indicates that the clip is properly secured.

9 Step

Pull the middle strap of the car seat forward until the child is secured.

10 Step

The distance between the strap and the child's body should be a maximum of 1cm. To ensure the straps are properly tightened, perform the "pinch test" - if you can grab and pinch the strap, it should be tightened more.

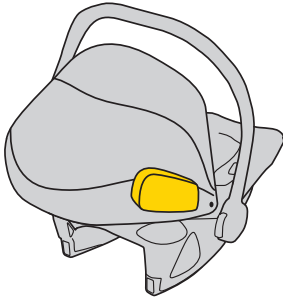
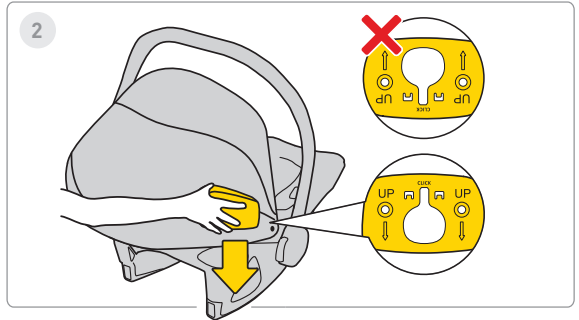
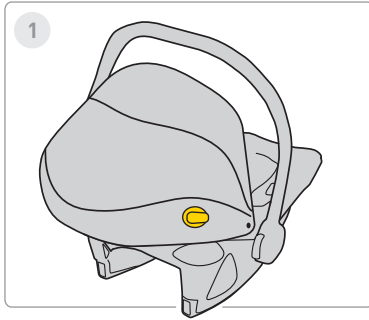

1 Step

The car seat has a bumper mounting on both sides.

2 Step

Insert the bumper into the mounting. Remember, do not twist or move the bumper up and down.



3

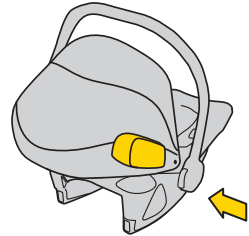
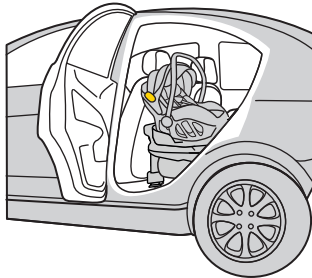
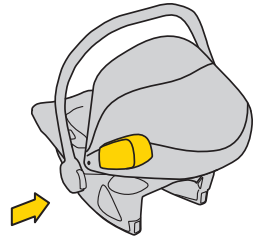
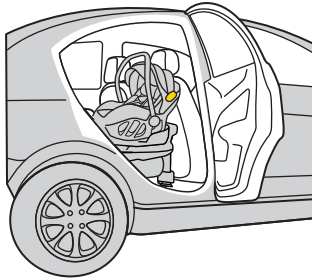

3 Step

Always mount the bumper on the car seat towards the vehicle's door side.

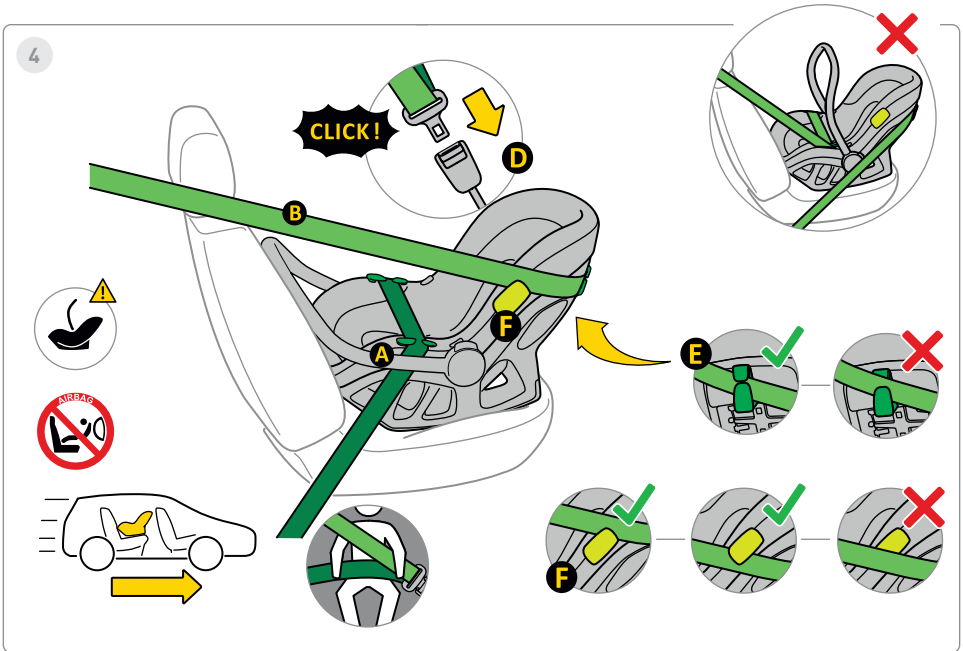

4 Step

1. Place the car seat on the vehicle seat, facing the direction of travel.
2. Keep the handle of the car seat in the upright position only for proper installation of the car seat in the vehicle.
3. Pull out the 3-point automatic safety belt **B** and place the pelvic section in the belt guide **C**.
4. Lock the locking mechanism **D** of the 3-point automatic safety belt in the vehicle's mounting.
5. Pull the pelvic section of the belt tightly so that there are no gaps in this section.
6. Lead the diagonal section of the belt behind the car seat through the belt guide **E**.
7. Lead the diagonal section of the shoulder strap over or under the bumper **F**.
8. To ensure the best lateral protection, remember that the bumper should always be mounted on the side of the door.
9. Check the tensioning of the belt, if there are gaps, pull the belt harder.

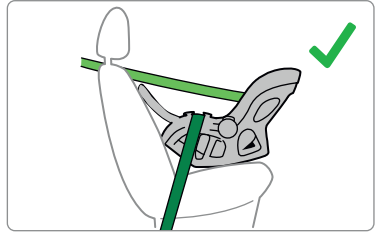
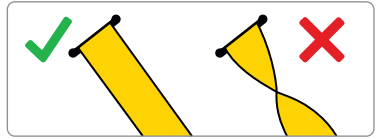
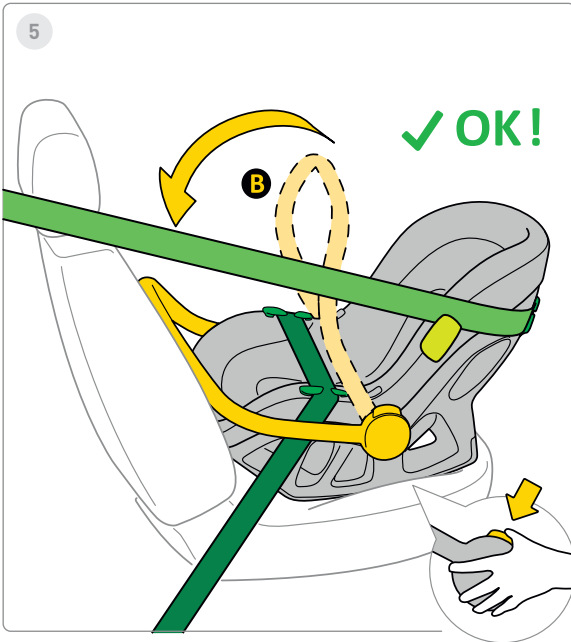

5 Step

1. After properly installing the car seat using the seat belts, press the handles **A**. On both sides of the car seat. Rest the handle on the back of the vehicle's seat.
2. The handle should be above the lower part of the car's three-point seat belt **C**

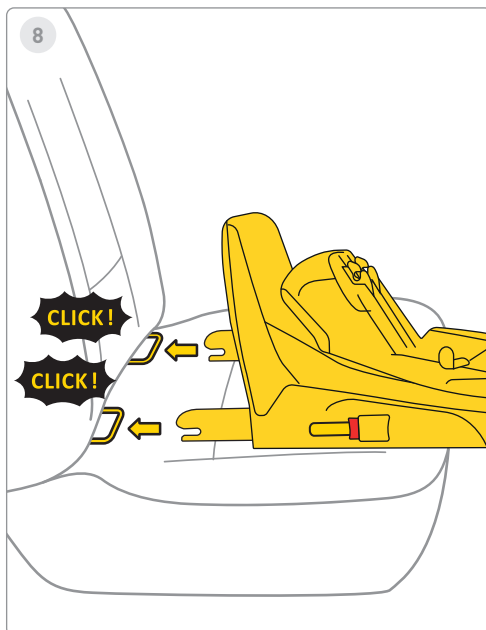
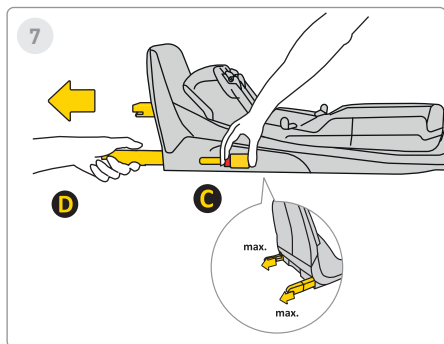
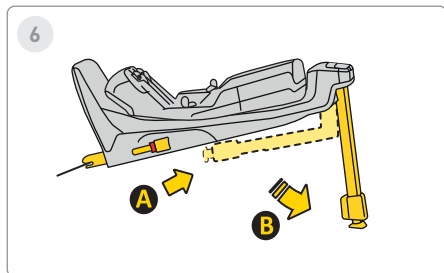

6 Step

Extend the stabilizing leg from position **A** to position **B**.

7 Step

Press the Isofix release button **C** and pull it out to its maximum position **D**.

8 Step

Align the base with the Isofix anchors in the vehicle's seat and push the Isofix arms until you hear a "click". The Isofix indicator changes from red to green, indicating a correct Isofix fastening.

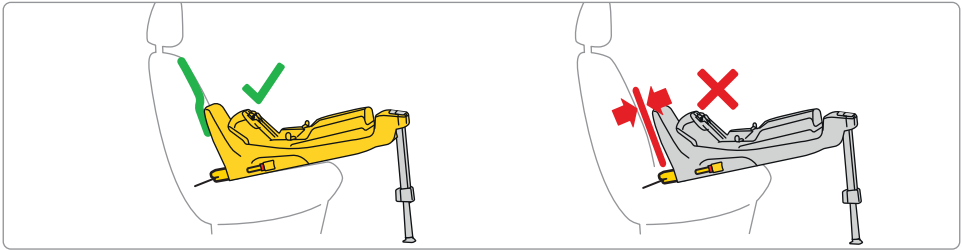
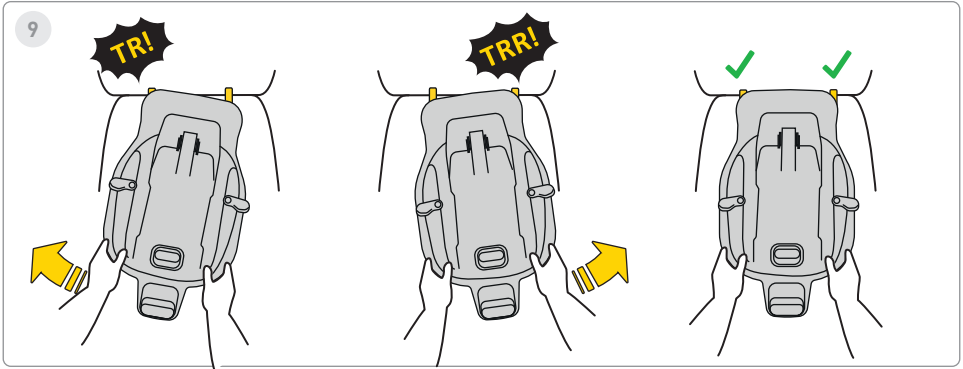

9 Step

Push the base towards the backrest of the vehicle's seat.
Remember, the base should be pushed as close as possible to the backrest.

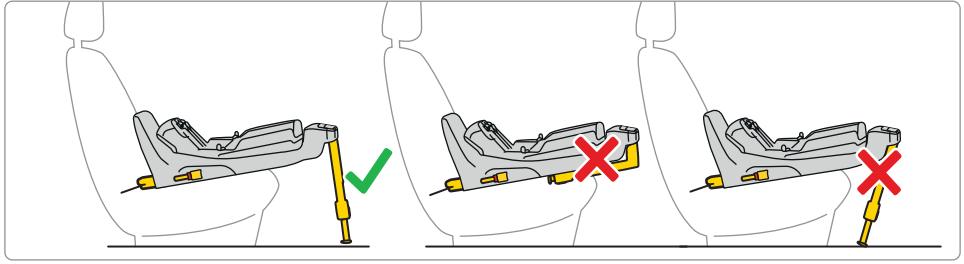
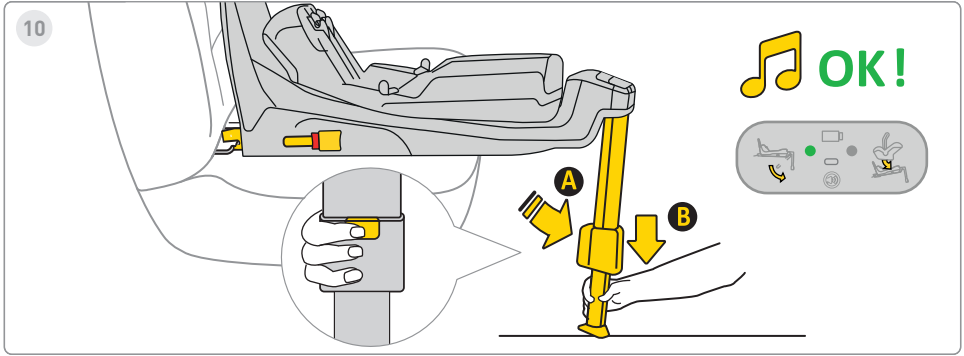

10 Step

Press the foot extension button **A** and extend the leg until the foot is firmly placed on the vehicle's floor. During proper installation, the foot's light on the display will change from red to green.



11

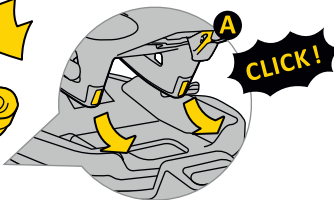
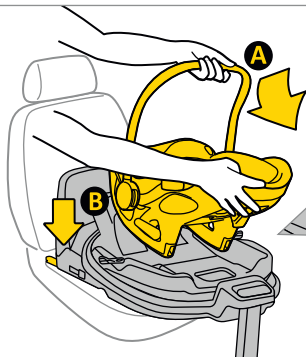

OK!

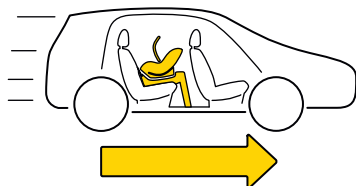

11 Step

Place the car seat in the base. To do this, insert the car seat from side **A** into the base's hooks, and then push the car seat into place **B** in the base. After properly inserting the car seat into the base, a green light will appear on the display on the right side.



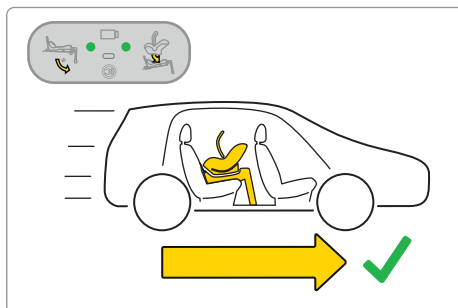
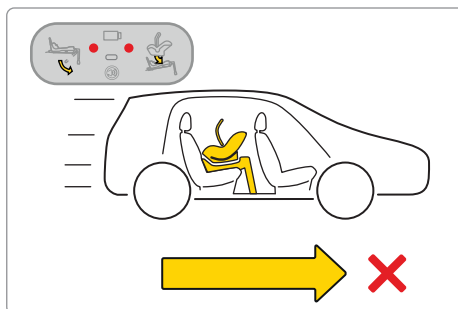
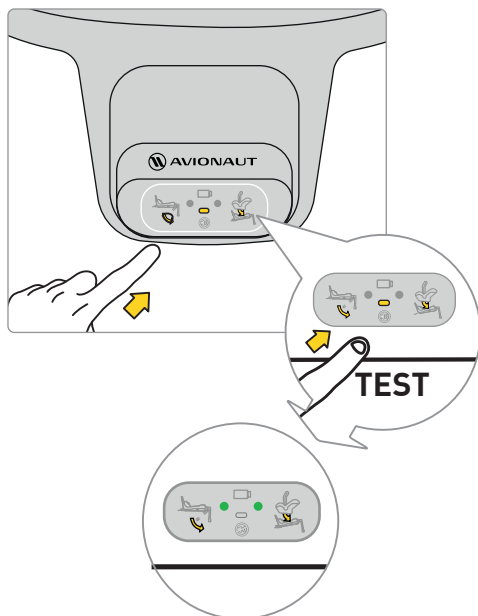







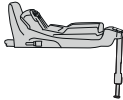



Remember: Only use the car seat with the back facing the direction of travel.



Before setting out on a journey with your child, perform a test of the base's electronic system. After properly securing the car seat and mounting the leg, two green dots should appear on the display.

If red dots appear, check if the car seat and base are correctly installed.



			
			
Sound			
Lights			

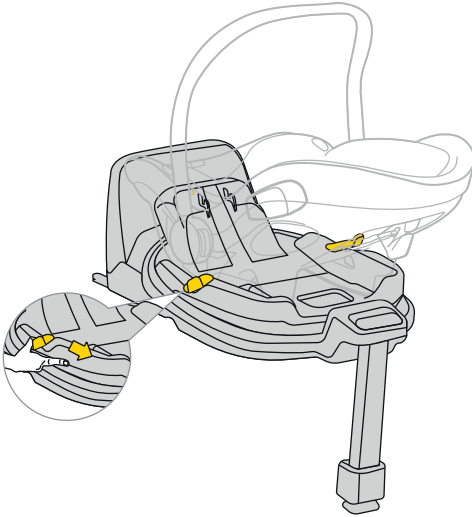

12

**12 Step**

To rotate the car seat, pull or push lever **A** and turn the seat with one hand in the desired direction.

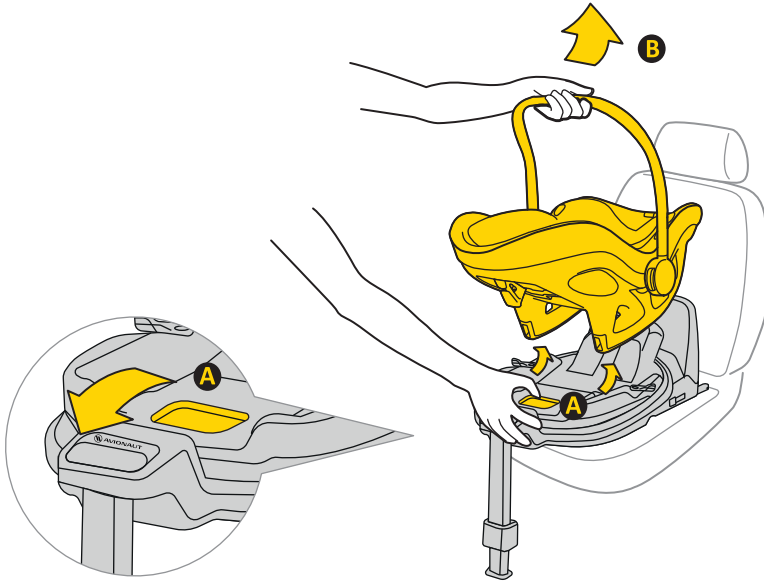

13

**13 Step**

To remove the car seat from the base, pull the release handle **A** and gently tilt the seat forward while lifting it up by the handle **B**.

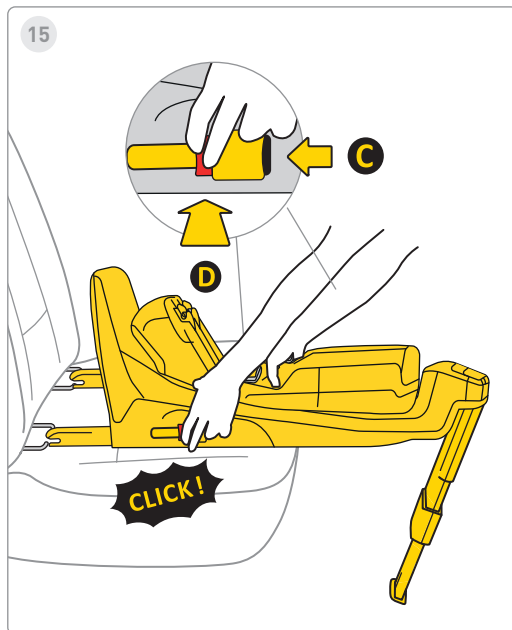
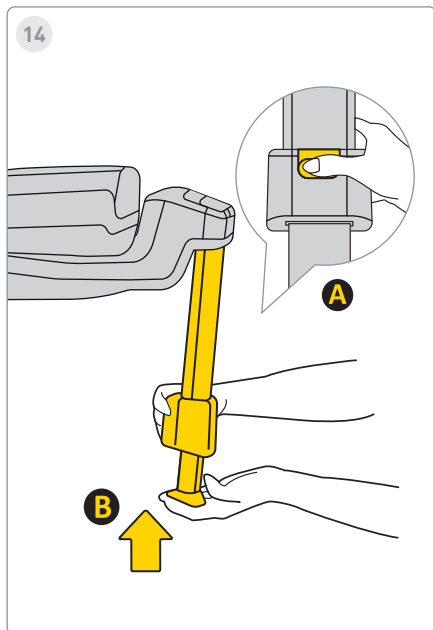

14 Step

To insert the leg, press the button **A** and insert leg **B** to its original position, and then fold it to save space.

15 Step

To uninstall the base from the car's Isofix attachments, first press the lock button **C** then press the release button **D** and fold the Isofix hooks back to their original position.

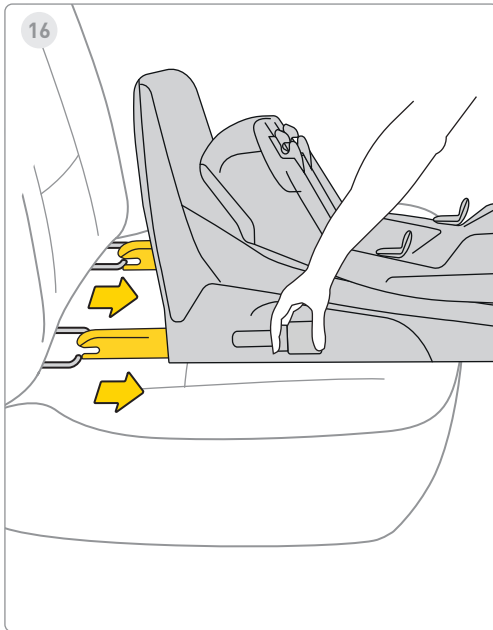

16 Step

Insert Isofix into maximum storage.

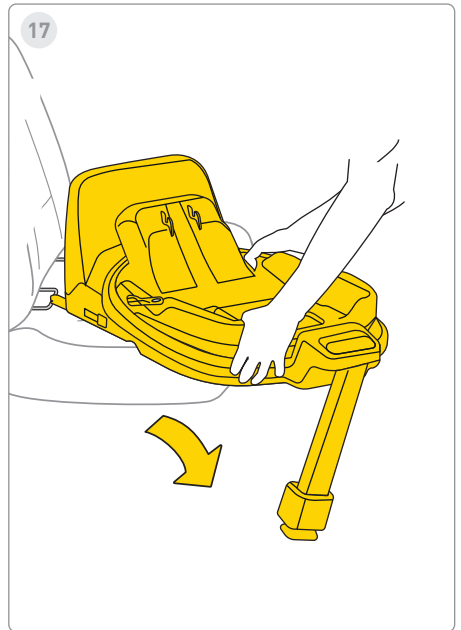

17 Step

Remove the base from the vehicle.

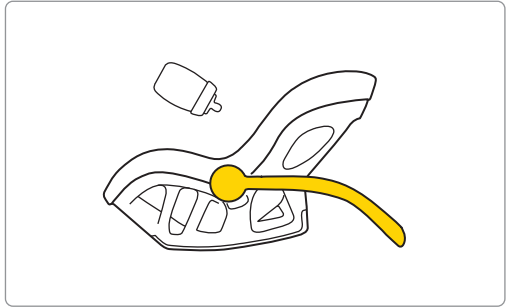
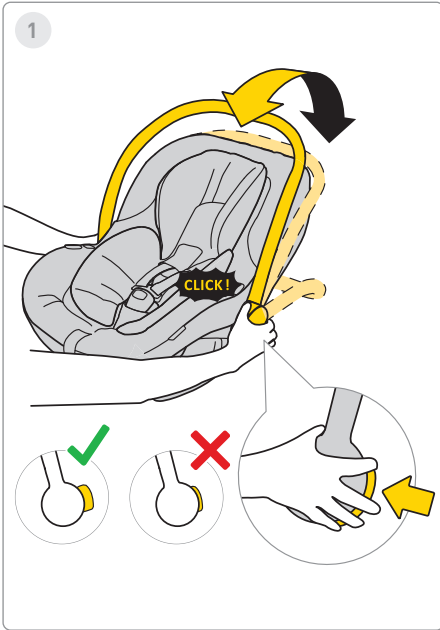

1 Step

To feed the child, press the buttons on both sides of the car seat and slide the handle behind the car seat. The handle can be rotated both backwards - behind the car seat, and forwards.

 **WARNING!**

The car seat is for transporting a child in a car. Do not use it as a pacifier.



2

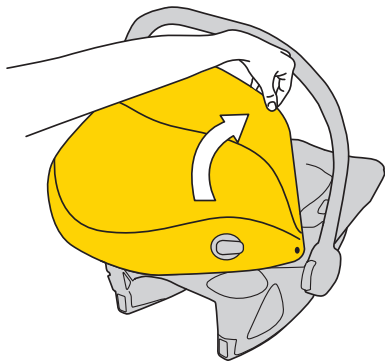

3

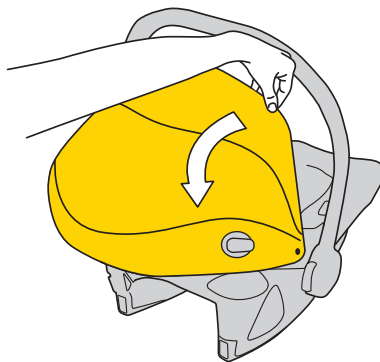
**2 Step**

To cover the sunshade, pull the plastic frame of the canopy and slide it to cover the child.

3 Step

To uncover the sunshade, push the plastic frame behind the car seat.



4

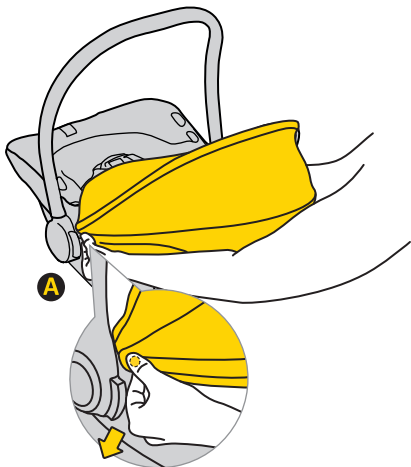

5

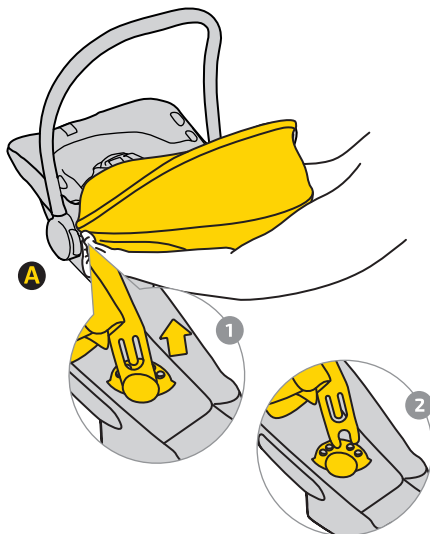
**4 Step**

To remove the canopy, unfasten fastener **A**

5 Step

Then pull the plastic frame of the canopy **1** and pull it out of the mounting **2** on both sides of the car seat.



6

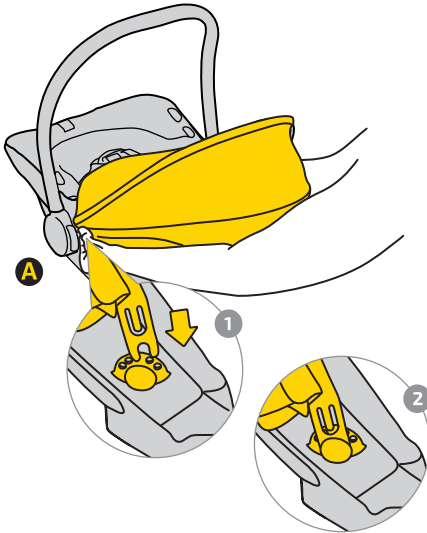

7

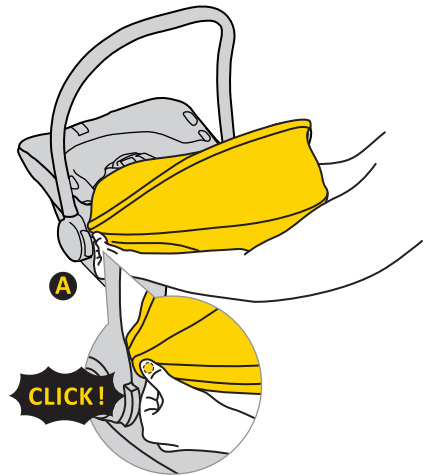
**6 Step**

To attach the canopy to the car seat, mount frame 1 and press it against the canopy mount.

7 Step

Then fasten the canopy fabric fasteners **A** to the shell.

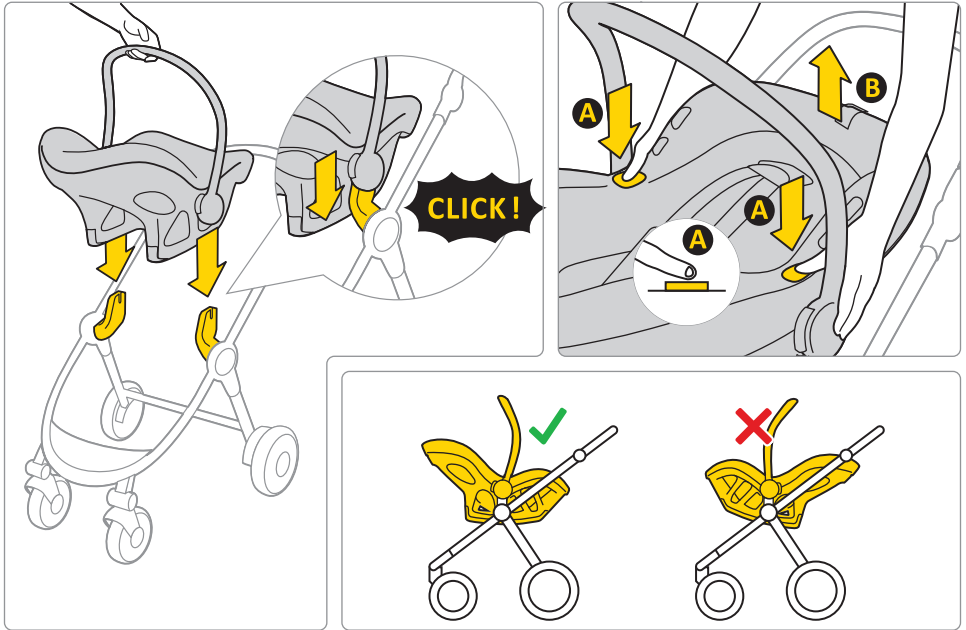

The Pixel Pro 2.0C car seat can be mounted facing the parent on any approved stroller.

To remove the car seat from the stroller frame, press button **A** on both sides of the car seat and lift it up.

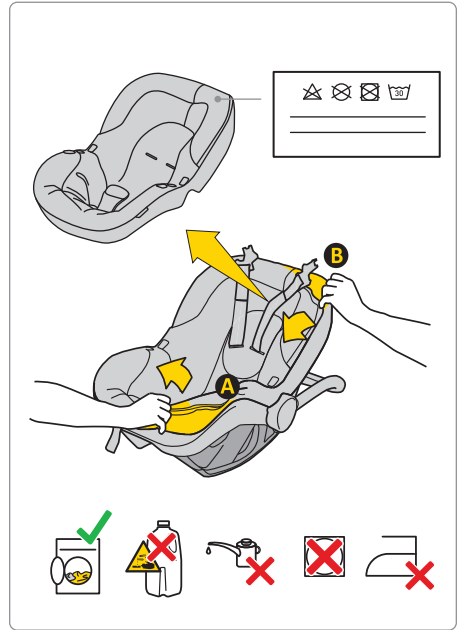

To wash the upholstery, follow the provided washing instructions. You can easily remove the upholstery from the car seat. Follow the instructions shown in the pictures.

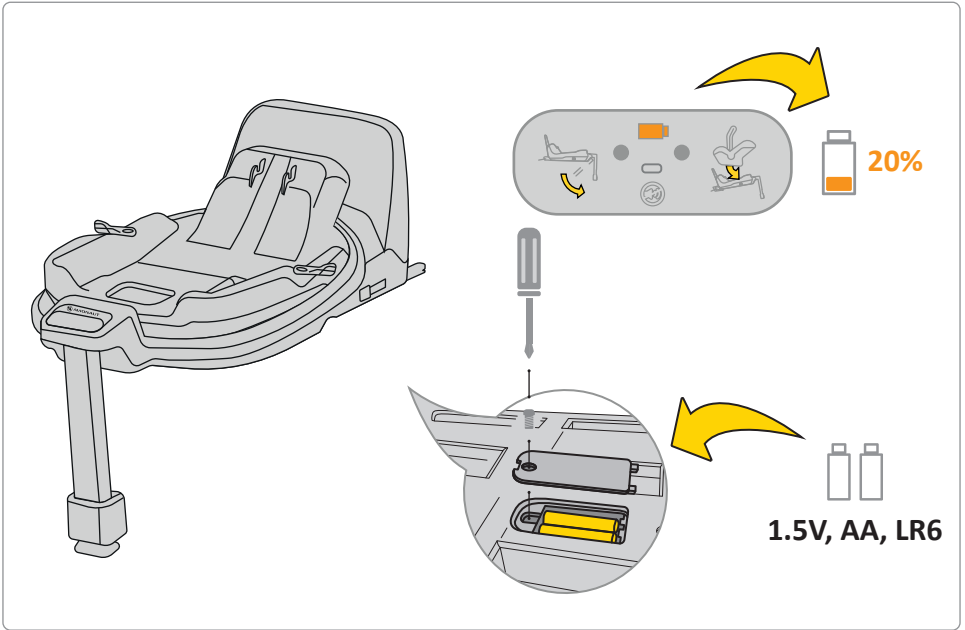

If the battery indicator on the display is orange, it needs to be replaced. To do this, remove the cover at the base and take out the batteries.

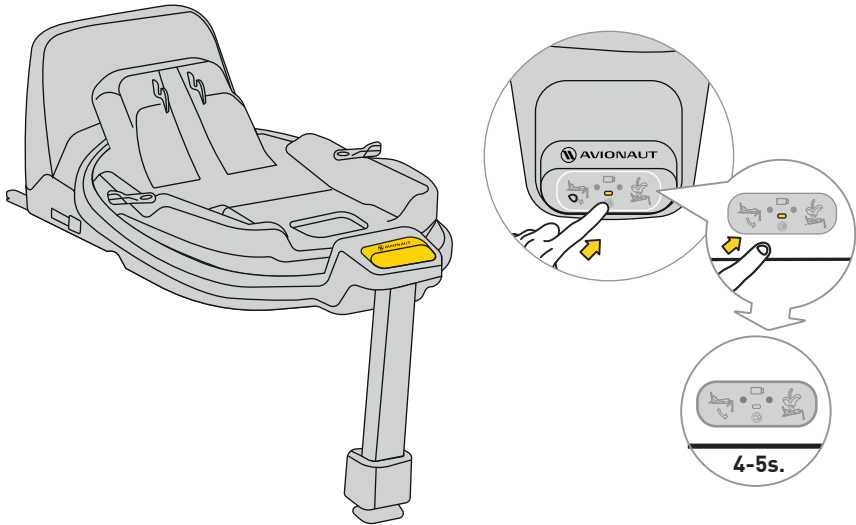

To mute the sound, press the display button for 4-5 seconds. The display will still show the correct/incorrect seatbelt and base attachment, but the sound will be muted.

Safety, use and travel

- Before purchase, each child safety seat should be installed in the car to check whether it can be properly installed and used in a given car. Matching the child safety seat model to the car type is one of the most important safety criteria. The seller's assistance during the first installation also guarantees that the installation will be fully correct.
 - Remember that parents are always responsible for the safety of the child while driving.
 - Never leave the child in the safety seat unattended in the car or outside it.
 - Never hold your child on your lap while the car is in motion.
 - The safest place for your child while travelling is the back seat of the car.
 - Before each trip, make sure that the seat belts are not damaged or twisted.
 - When the child safety seat is installed, the rear seat backrest must be locked and cannot move.
 - Before each trip, make sure that the Pixel PRO 2.0 C child safety seat has not been pinched in the door or exposed to the movement of luggage or the seat backrest.
 - Make sure all luggage in the car is securely attached.
 - Do not use the Pixel PRO 2.0 C child safety seat without upholstery, as it is part of the child safety system.
 - Take short breaks during longer trips. Your child also needs movement.
 - Always cover the child safety seat when you leave the car parked in a sunny place. The upholstery as well as the metal and plastic parts can get extremely hot and burn your child.
 - Always secure the child in the safety seat by fastening the child with the harness belts, also when using the safety seat outside the car.
 - Make sure that the harness belts are properly fastened so that the child is correctly positioned in the seat.
 - We do not recommend buying used child safety seats – you can never be sure of their history. However, if you decide to buy a used child safety seat, choose one whose use history is known.
 - Do not use the Pixel child safety seat for more than 10 years.
 - Replace your child safety seat if it has been involved in an accident.
-

- Do not make any modifications to the child safety seat. They may cause partial or total loss of product safety.
 - The child safety seat must always be secured in the car, even if no child is carried in it.
 - The manufacturer takes into account the fact that the child safety seat can leave dents in the upholstery of the vehicle seat. This is unavoidable due to the requirement of tight fitting of the safety seat. The manufacturer is not responsible for any damage caused by this.
 - Make sure that the belts are properly fastened so that the child is correctly positioned in the seat.
 - Harness belts holding the child cannot be used without covers.
 - Make sure that you can place a maximum of one finger between the harness and the child (1 cm). If this distance is greater, tighten the harness,
 - The Pixel PRO 2.0 C insert consists of several elements. Adjust them so that the height of the seat's harness belts puts them parallel to the level of the child's shoulders. **REMEMBER:** Each child has different body proportions – check the belt position in relation to the shoulders on a regular basis. This is necessary to maintain the child's safety in the seat,
 - If you want to protect your child from the sun, attach and unfold the sun visor. The visor is a separate part of the child safety seat,
 - Use the Pixel PRO 2.0 C child safety seat when your child is between 40 cm and 86 cm tall and weighs not more than 13 kg,
 - When installing the Pixel PRO 2.0 C seat, use the seat facing forwards, which is equipped with three-point safety belts, the belts should be tightened and pulled through all points of the seat marked in blue. Instructions for the correct installation can be found in this manual and on the Pixel sticker, which is located on the side of the seat,
 - Use only a child safety seat facing forward that is equipped with three-point safety belts in accordance with the ECE R16 standard,
 - Test the correct installation of the child safety seat. If one of the LEDs lights up red, correct the seat installation and perform the test again. Do this until the green LED lights up.
 - The Pixel PRO 2.0 C safety seat is sold in a set including a bumper which must be placed on the side of the safety seat.
-

Maintenance and hygiene

1. The upholstery of the Pixel PRO 2.0 C child safety seat can be machine washed at temperatures up to 30°C at speeds up to 600 rpm.
2. Other elements of the safety seat can be washed with soap and a soft sponge.
3. Keep your child safety seat clean. Do not use any moisturising agents or aggressive cleaning agents.
4. Do not use any lubricants, harsh chemicals or moisturisers for moving parts or other parts of the seat.

Environment

- Keep plastic packaging parts out of reach of the child to avoid the risk of suffocation.
- The batteries powering the information panel placed in the base of the child safety seat are subject to proper disposal.
- For reasons of environmental protection, after using the seat, please dispose of it in the appropriate waste management facility, in accordance with applicable local regulations.

Questions

If you have any questions, call your seller or authorised distributor. Prepare the following information:

- The age, height and weight of your child,
- The make and type of the car and the position of the seat on which you will install the Pixel PRO 2.0 C child safety in the car.

Warranty

- The Pixel PRO 2.0 C child safety seat is covered by a 24-month warranty.
- We hereby assure you that the product has been manufactured in accordance with current EU requirements regarding safety and quality standards and that at the time of purchase the product is free from manufacturing and material defects.
- The warranty is valid in the country of purchase and is satisfied by the authorised distributor.
- The warranty covers all manufacturing defects in regard to the materials and workmanship, provided that the product is used in accordance with the user's manual, under normal conditions, by the first end-user and within 24 months from the date of purchase. Avionaut assumes responsibility for the repair or replacement of the defective product, but the

guarantor decides about the choice of how to remove the defect and process the complaint.

- The warranty does not cover damage caused by daily use, such as the wear of fabric as well as the natural loss of colours and deterioration of the materials resulting from the normal ageing of the product.
- The warranty also does not apply in the event of damage to the product due to accidental damage, non-observance of the user's manual, improper use, damage due to negligence, fire, contact with liquid or other external causes.
- At the time of filing a complaint, the Pixel PRO 2.0 C child safety seat must have all labels or an identification number and may only be serviced by a person authorised to do so.

Do you want to file a complaint?

- Do you want to file a complaint? When you see a defect and want to file a complaint, please contact the seller from whom you purchased the Pixel PRO 2.0 C seat. When making a complaint, you must provide proof of purchase that must be made within 24 months prior to the service request.
- If it is necessary to send the product to a service centre, you should return the product to the

distributor or seller. At the same time, the shipping method and its costs should be agreed on, because in the absence of such agreement, the guarantor may refuse to cover the shipping costs. Damage and/or defects that are not covered by our warranty or consumer rights, and/or damage and/or defects of the product not covered by our warranty may be removed at the agreed fee.

- Replace your child safety seat with a new one if it has been involved in an accident. To do this, you will need: a note from the police regarding the accident, a photo from an accident with a visible seat or information from the police about this fact, proof of purchase, confirmation from the insurer of not including the child safety seat in the insurance claim, the warranty card and sending the seat, which was involved in the accident to us.

Consumer rights

- The consumer has rights in accordance with relevant legislation, which may vary from country to country. This warranty does not affect consumer rights subject to relevant national legislation.
-

- This warranty has been prepared by Ł.KARWALA, a company registered in Poland.

Company address:

Ł.KARWALA

Szarlejka,

ul. Lukaszewicza 172

42-130 Wreczyca Wielka, Polska

(1) Purchased products with removed or altered labels or identification numbers are considered unauthorised. Due to the fact that the authenticity of such products cannot be determined, the warranty does not cover them.

GUARANTEE CARD

NO	START DATE OF	RANGE OF REPAIR	DATE OF COMPLETION	SIGN

SELLING DATE

SHOP STAMP

ADRESS:

Ł.KARWALA

Szarlejka, ul. Łukaszewicza 172

42-130 Wręczyca Wielka

POLAND

Telefon: +48 34 317 66 10

Fax: +48 34 317 66 95

E-mail: avionaut@avionaut.com

www.avionaut.com